

Lyskassebund ligger 80cm under Terræn. Afløb fra Lyskasse består af 10cm Lerrørsbøjning m/ løs Rist
 20 Bt, ca. 100cm under Terræn

KÆLDERPLAN 1:100

STUEPLAN

1'SALSPLAN

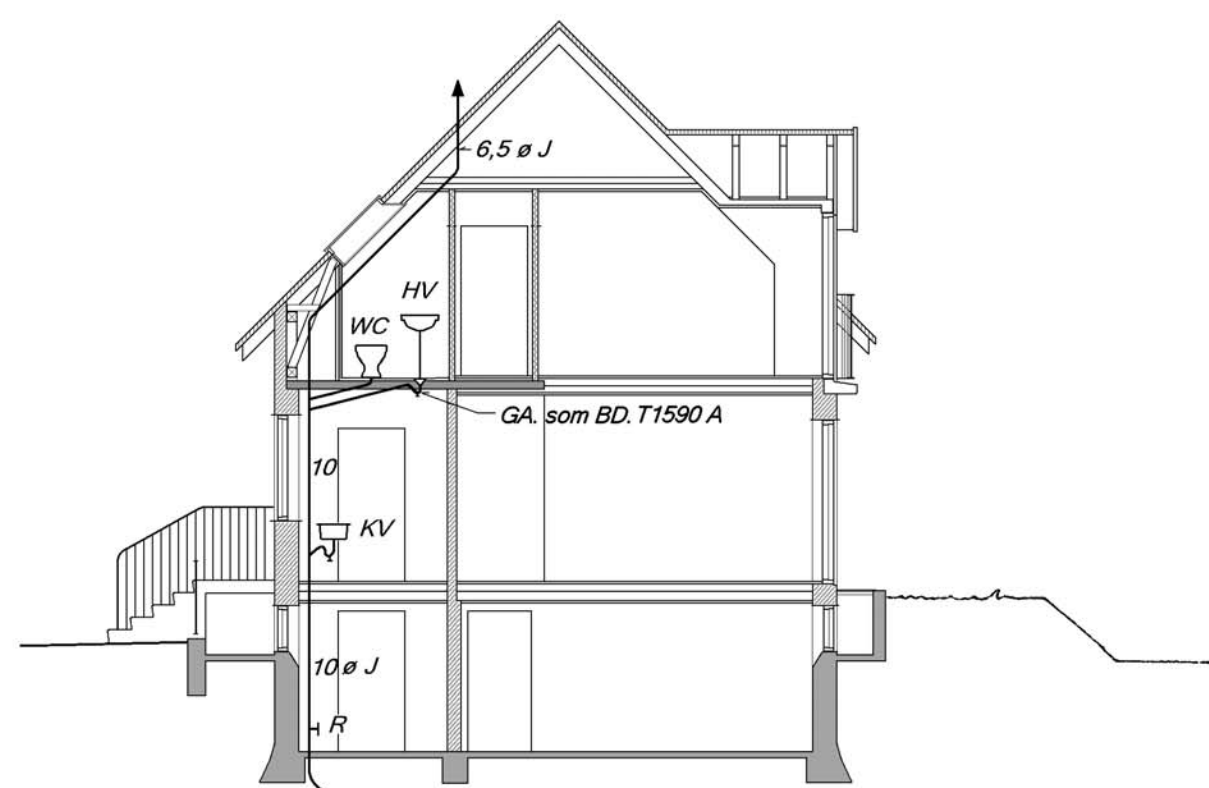

SNIT 1:100

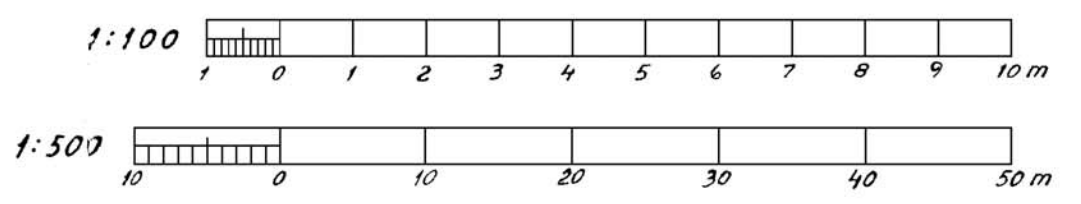

Nord ↑

Færdige Terrænkoter

ved Nordfacade:	5,10	5,30	5,50	5,70
ved Sydfacade ca.:	5,80	6,00	6,20	6,40

6,80	7,00	7,20	7,40
7,50	7,70	7,90	8,10

7,70	7,90	8,10
8,40	8,60	8,80

8,20
8,90

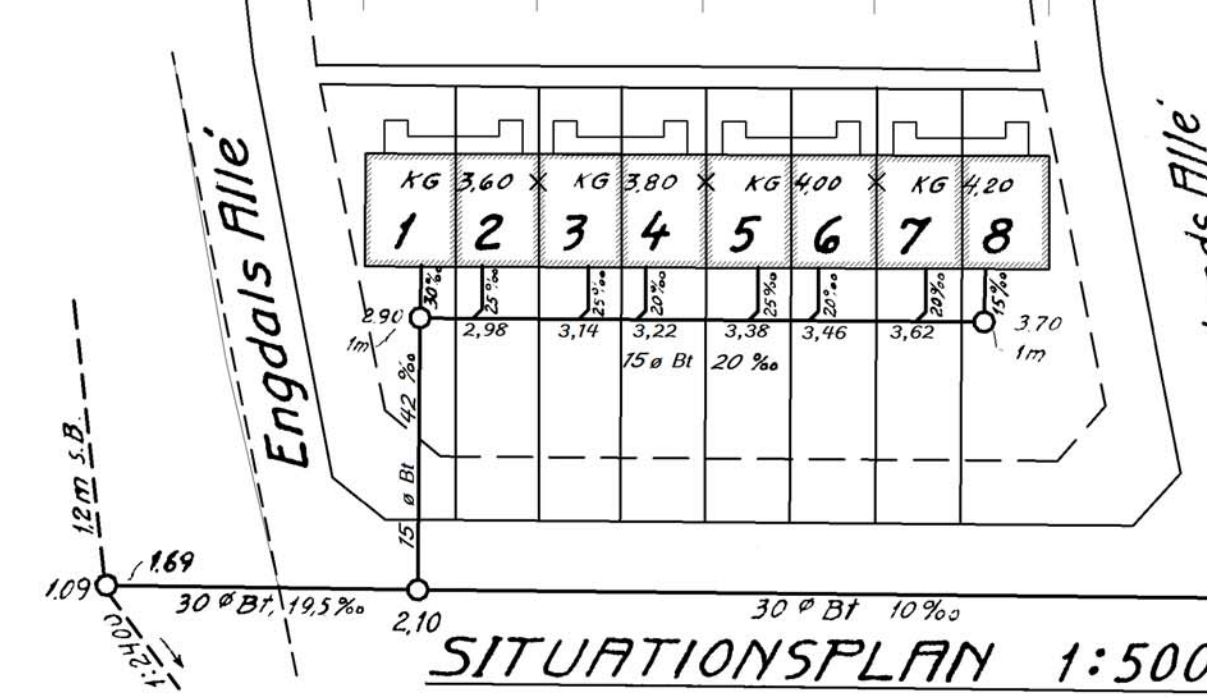

SITUATIONSPLAN 1:500

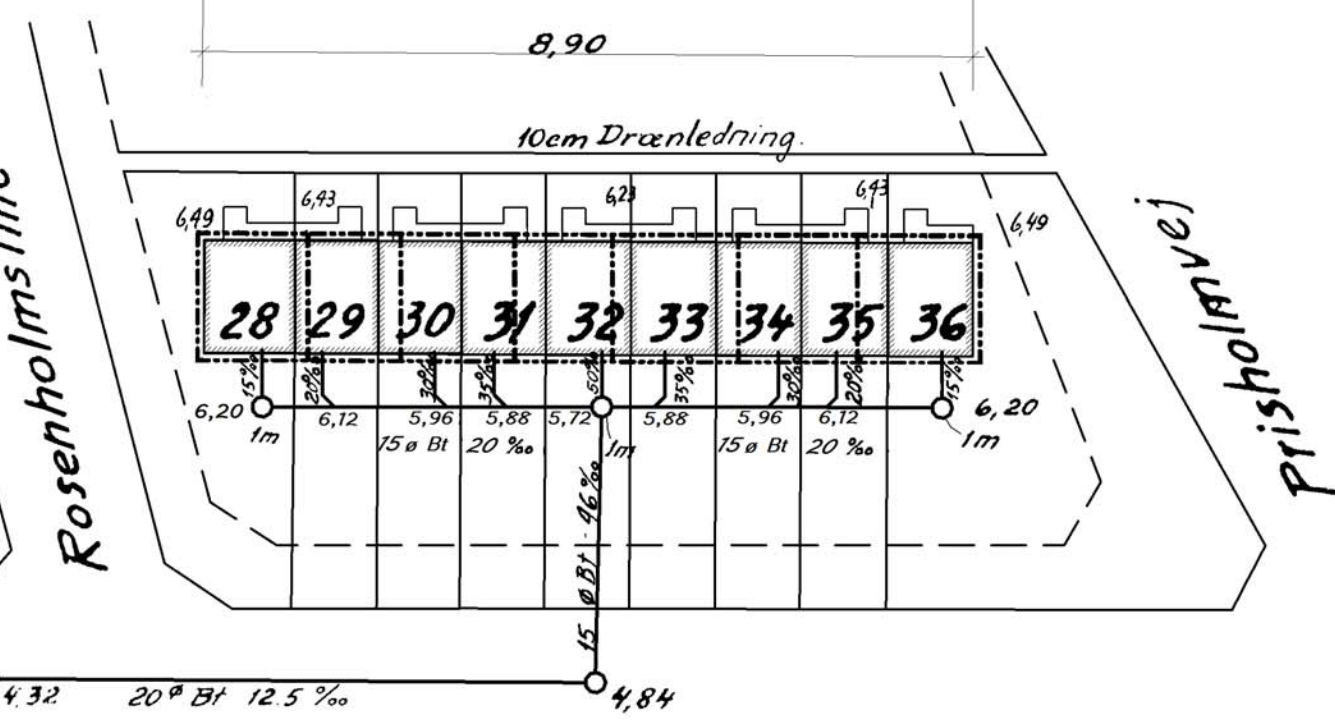
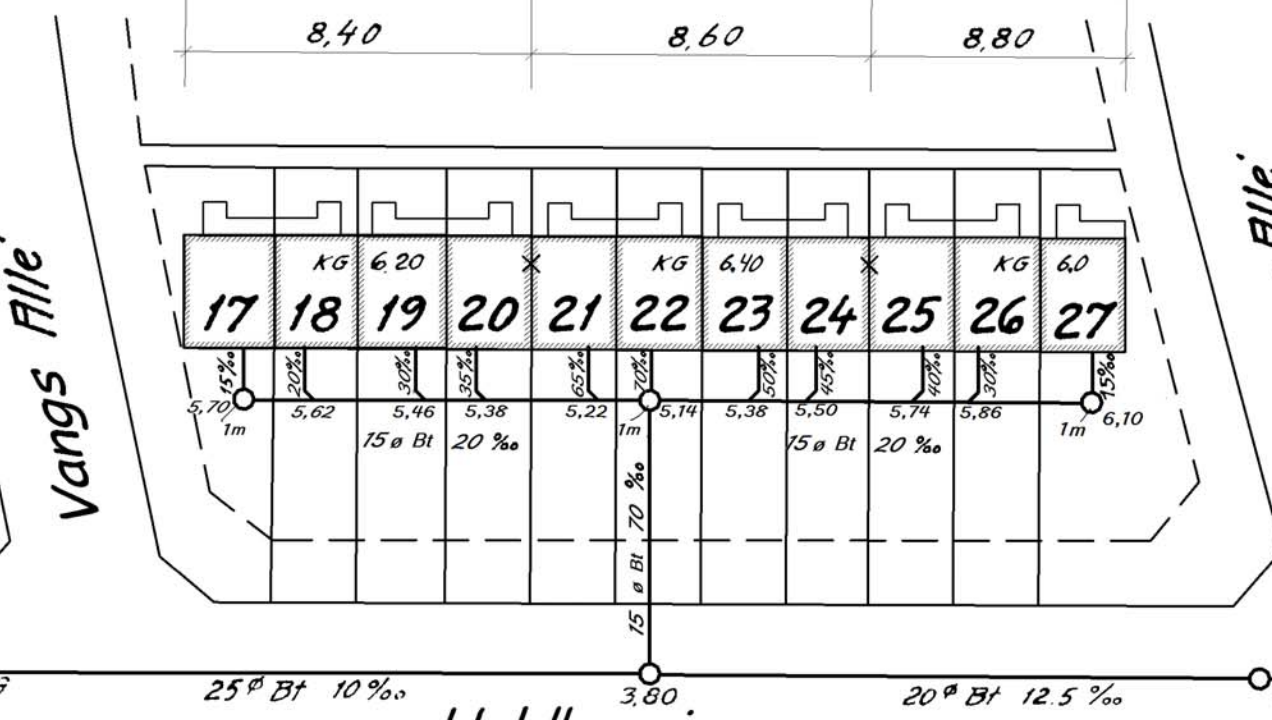
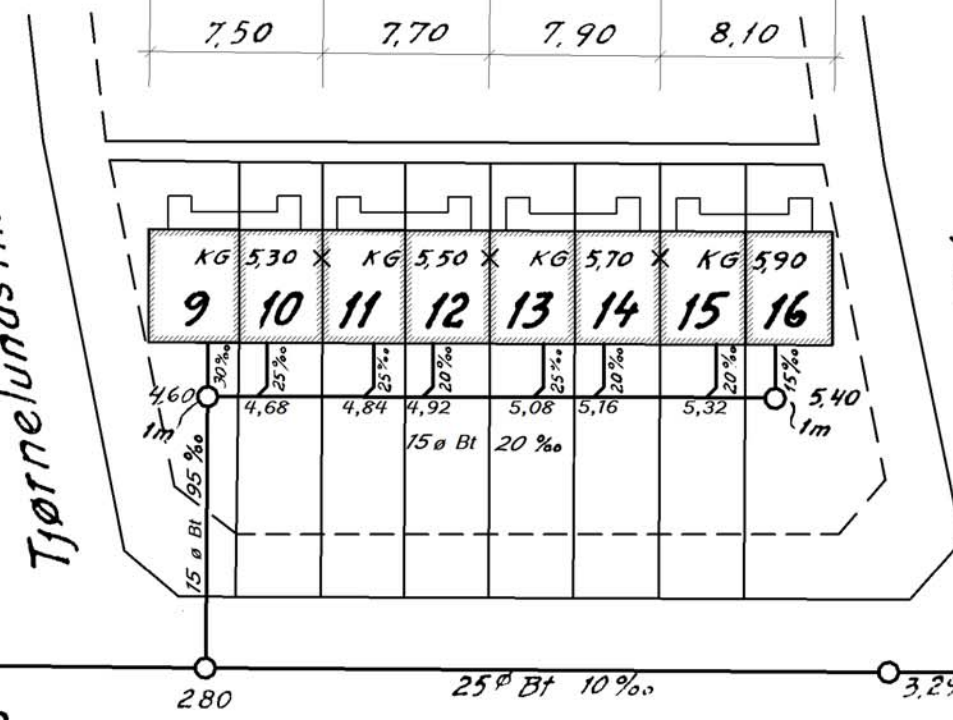

Heldbovej

Rentegnet kopi sep. 2011

Heldbovej, Hus Nr.		Dræningsplan	
Matr. Nr. af Vigerslev			
Revisionsmærke:	a	b	c
Revisionsdag:	15/3-45	5/4-45	1/6-45
AUG. TEYTAUD INGENIØR M. a. I. SDR. FASANVEJ 50, VALBY 5080		Dato: 24-8-44.	Tegn. Nr. 406
		Sag Nr. 40	
		Maal: 1:100 1:500	

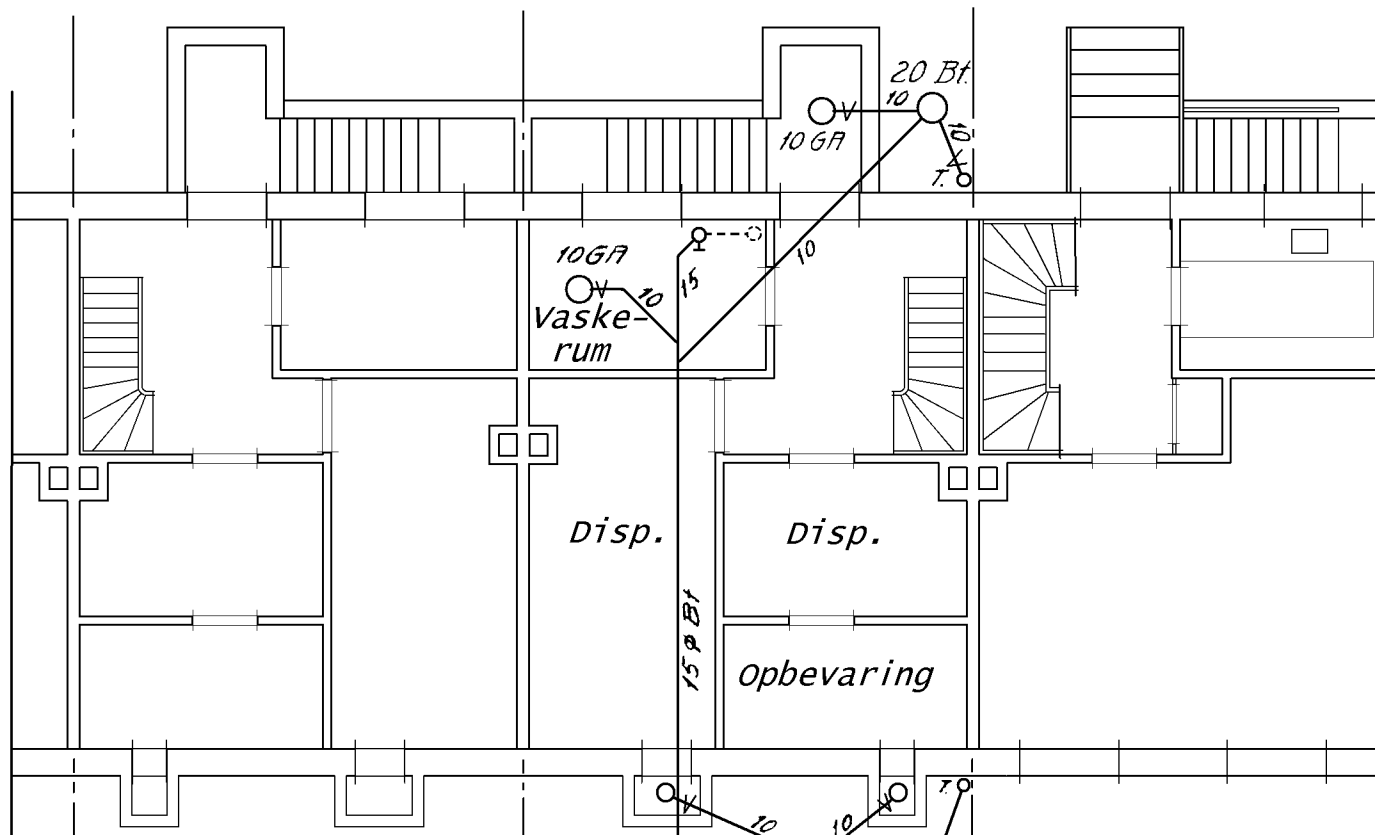

Lyskassebund ligger 80cm under Terræn. Afløb fra Lyskasse består af 10cm Lerrørsbøjning m/ løs Rist

KÆLDERPLAN 1:100

Færdige Terrænkoter

ved Nordfacade:	5,10	5,30	5,50	5,70	6,80
ved Sydfacade ca:	5,80	6,00	6,20	6,40	7,50

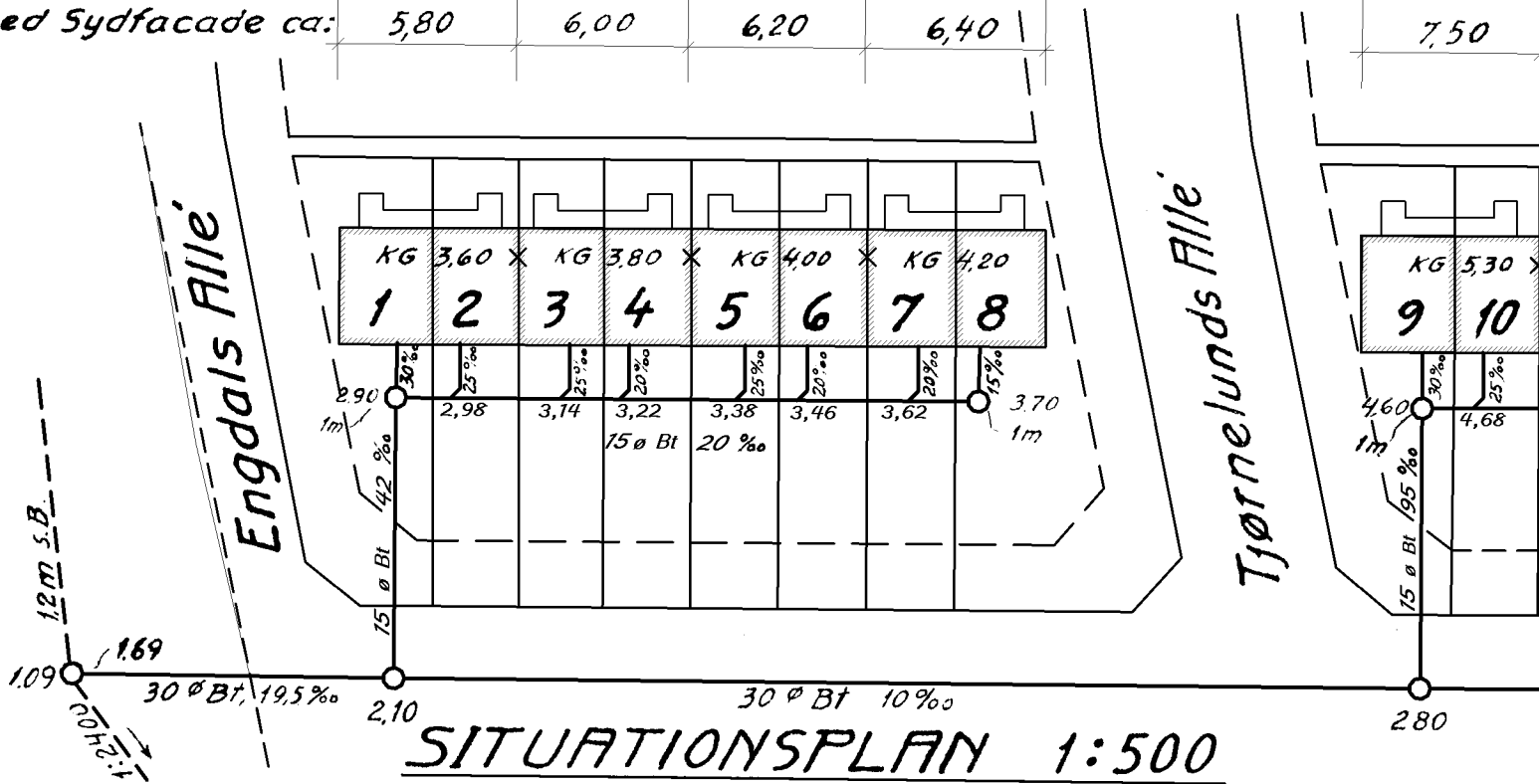

SITUATIONSPLAN 1:500

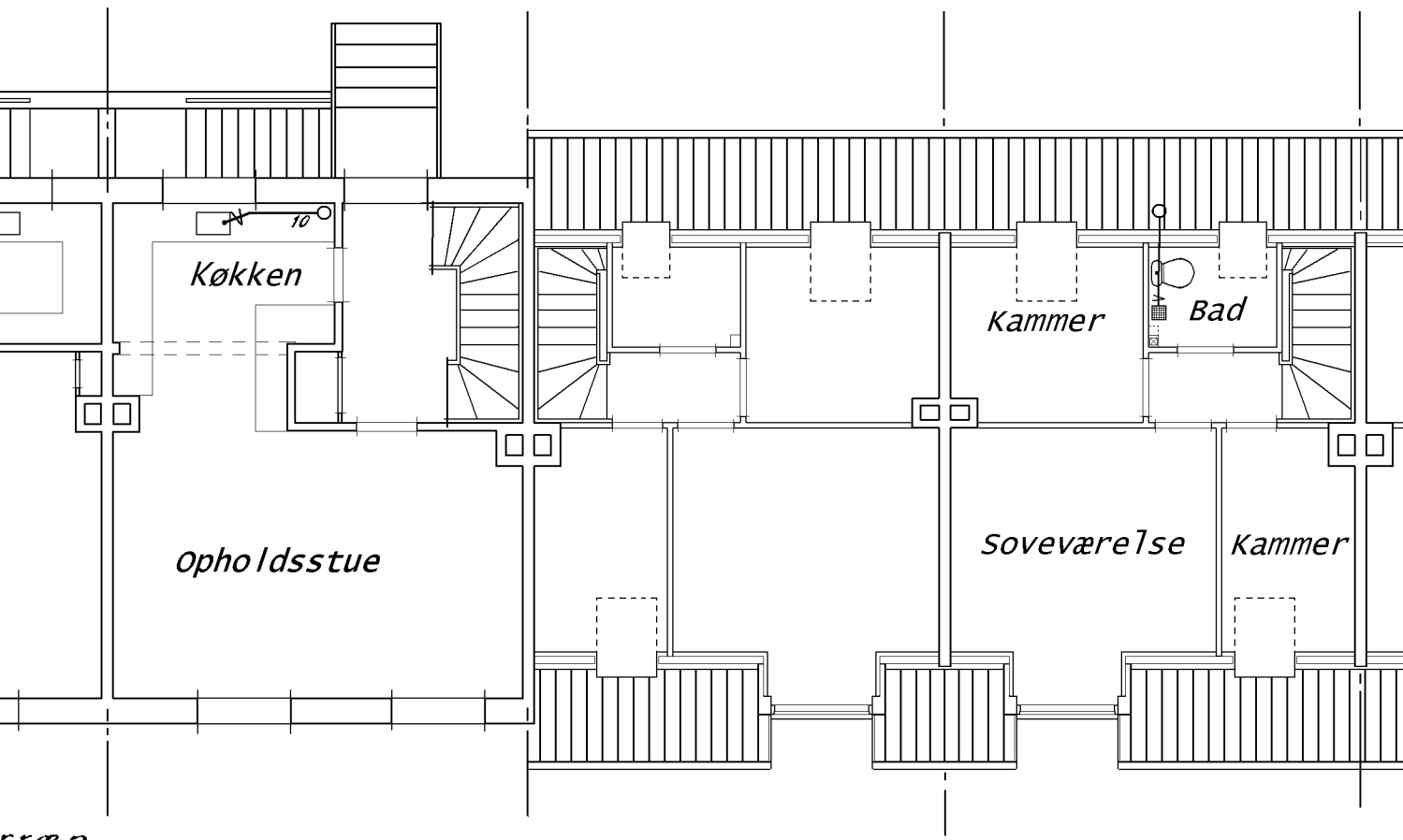

STUEPLAN

1' SALSPAN

0	7,00	7,20	7,40
0	7,70	7,90	8,10

7,70	7,90
8,40	8,60

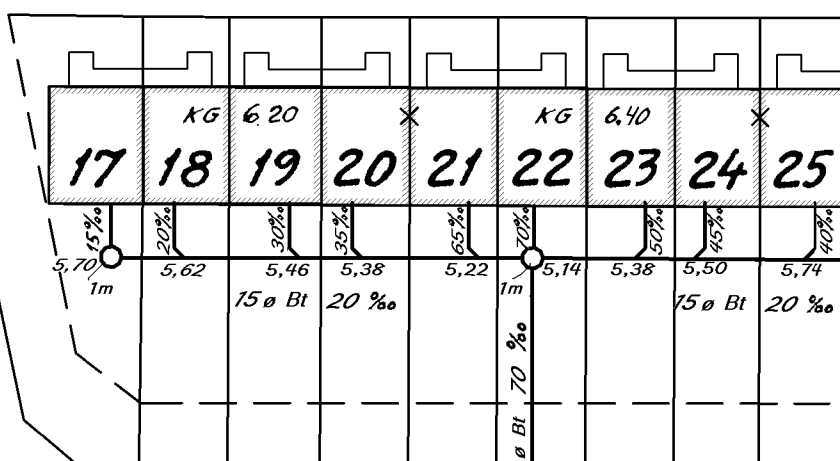
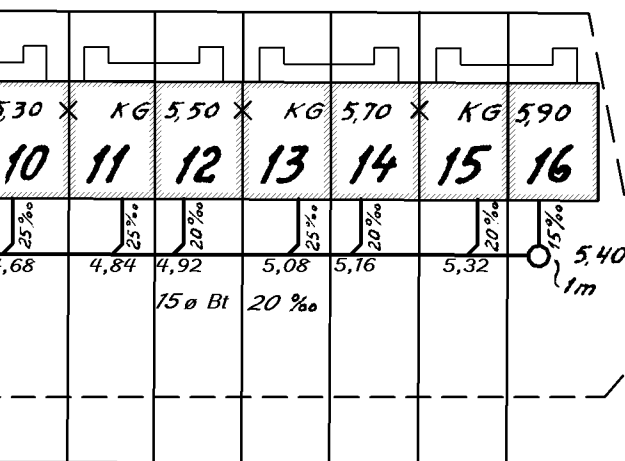

Vangs Alle

25 Ø Bt 10%

3,25

25 Ø Bt 10%

3,80

Heldbovej

20 Ø

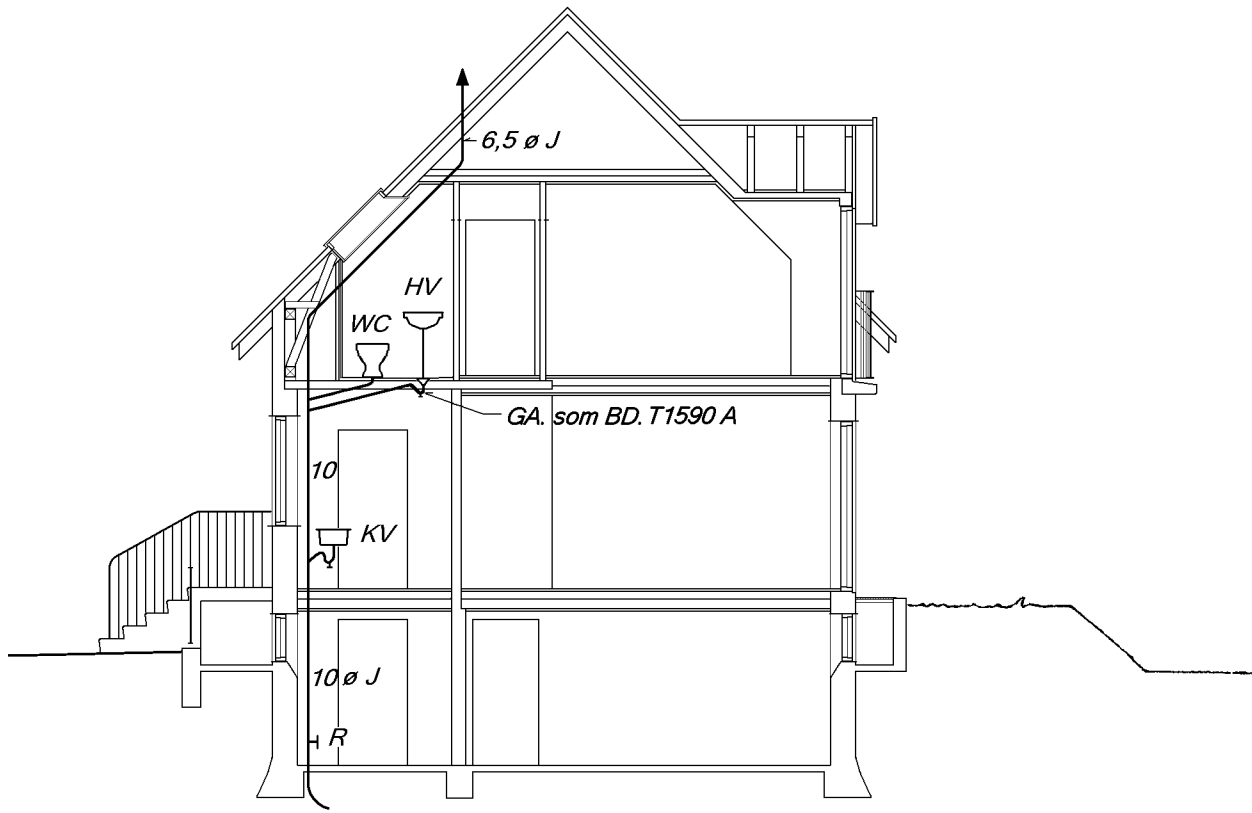

SNIT 1:100

Nord

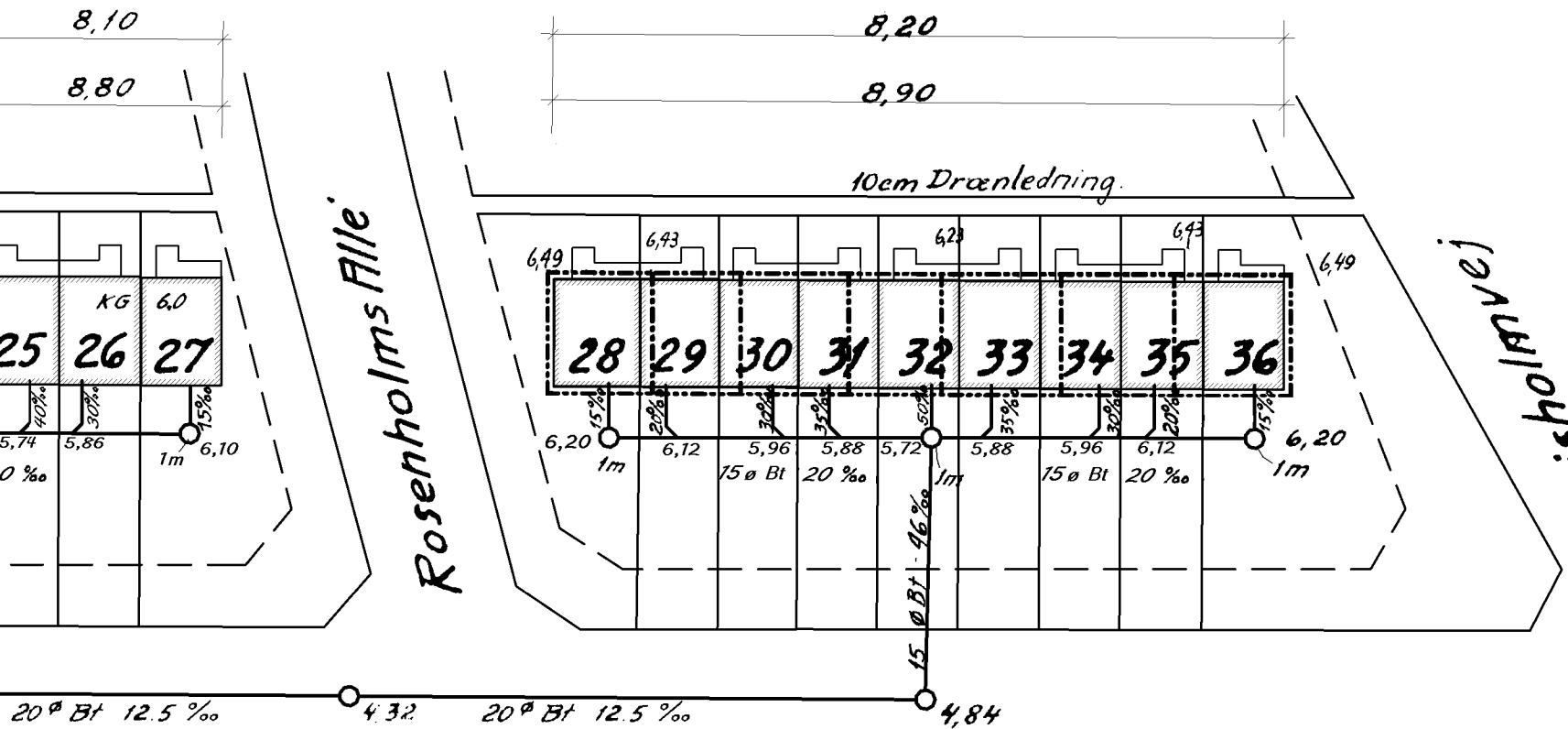

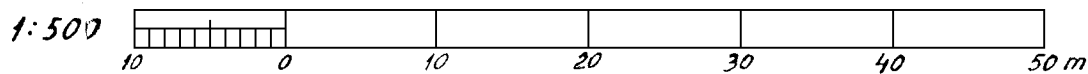
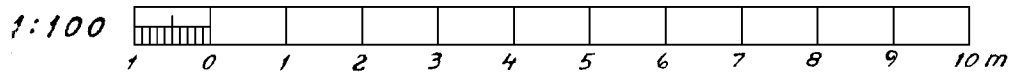

Rentegnet kopi sep. 2011

Prishold

<i>Heldbovej, Hus Nr.</i>				<i>Dræningsplan</i>				
<i>Matr. Nr.</i>				<i>af Vigerslev</i>				
Revisionemærke:	a	b	c	d	e	f	g	h
Revisionsdag:	<i>15/3-45</i>	<i>5/4-45</i>	<i>11/6-45</i>					
AUG. TEYTAUD INGENIØR M. a. I. SDR. FASANVEJ 50, VALBY 5060				Dato: <i>24.-8.-44.</i>				
				Sag Nr. <i>40</i>		Tegn. Nr. <i>406</i>		
				Maal: <i>1:100</i>				
				10. JUNI 1946				